



Denier Manufacturing

# Conduit / Mounting Bracket – Installation Notes For Mounting A Box To A Bracket. Cat. # S1C

A product of Denier Manufacturing. 10891 State Route 128 Harrison, Ohio, 45030  
1-800-286-9601 @ www.roughinready.com



1. Bend the **Far Side Supports** back at 90 Deg.
2. Insert screws from electric box in to **Key Hole Slots** in Conduit Bracket.
3. Bend **Tab** down into box. This will lock the box screws into the **Key Slots**.

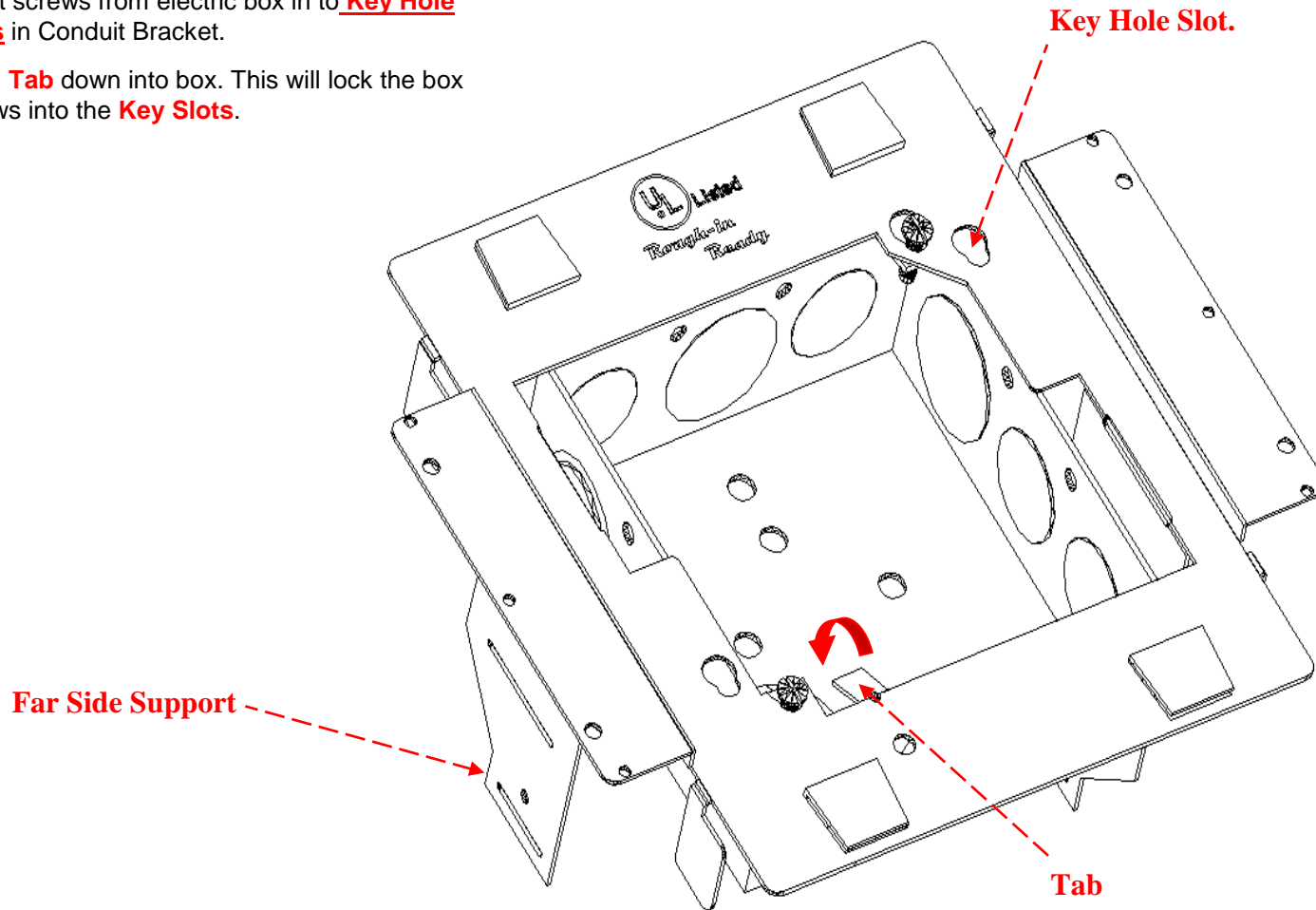



# Conduit / Mounting Bracket – Installation Notes For Mounting A Device To A Stud. Cat. # S1C

A product of Denier Manufacturing. 10891 State Route 128 Harrison, Ohio, 45030  
1-800-286-9601 @ www.roughinready.com



## To Attach The Conduit Mounting Bracket Directly To A Stud:

1. Far Side Supports come bent at 90° angle for 3 5/8" studs. For 3 1/2" and 2-1/2" stud depth, bend at the additional provided slots.
2. For stud depths of 5-1/2" or 6" use the Far Side Extensions (Ordered Separately). Slide the tab into the slot so that the small holes align. Secure with a small sheet metal screw. Bend at slot for 5-1/2" stud depth.
3. Place against the stud at the desired height and attach the bracket to the stud using the provided holes.
4. When terminating a conduit in this box, remove the Plaster Ring Assembly from the mounted Conduit Bracket. The box will remain attached to the bracket. Install conduit or tubing and wire as per NFPA 70 National Electric Code requirements for (EMT), (IMC), (RMC),
5. To install an AC-MC Cable Whip remove the KO and snap the connector into the box.
6. Terminate the appropriate conductors to the device with Wagos (provided) and reattach the Plaster Ring Assembly to the mounted Conduit Bracket.

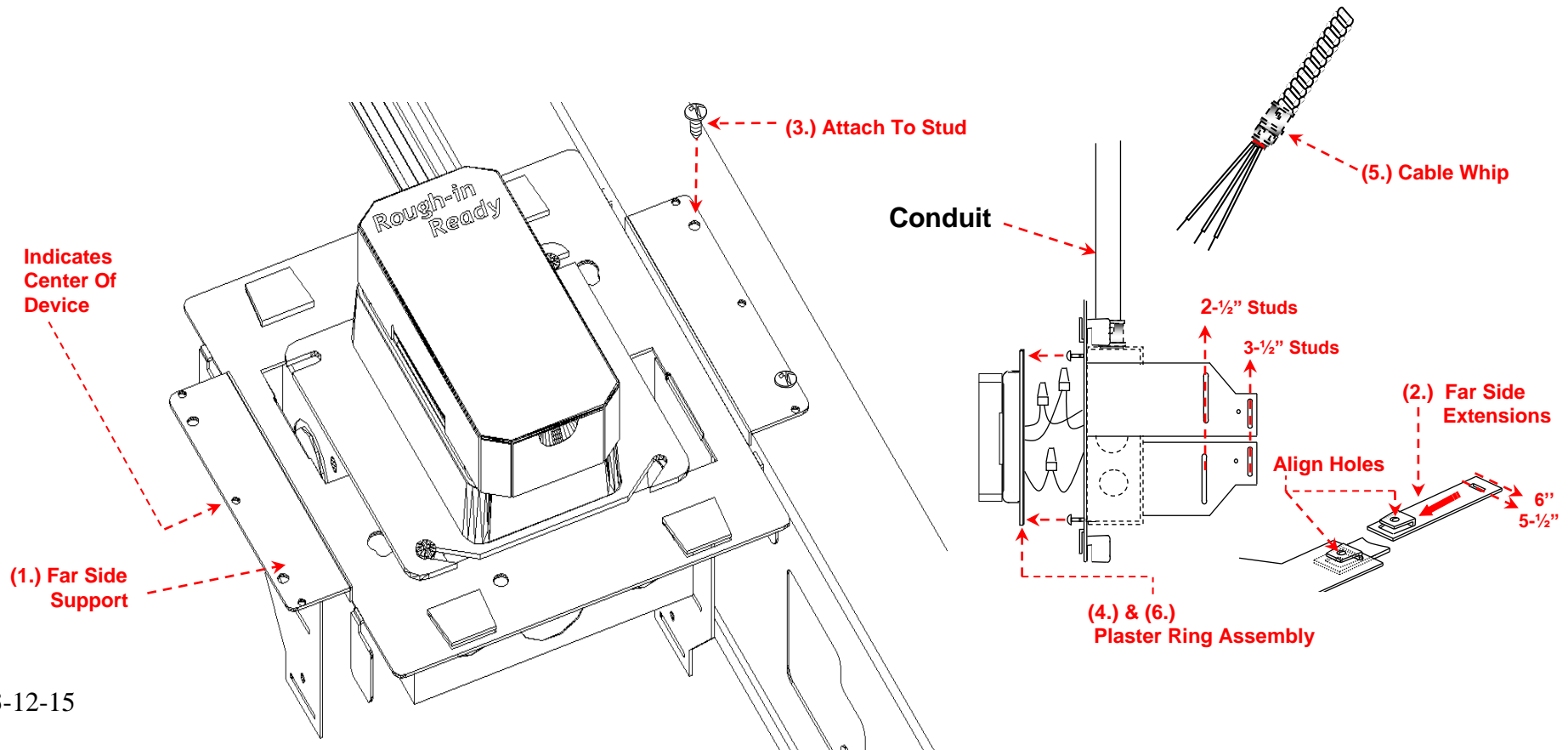

# Conduit / Mounting Bracket – Installation Notes For Dimensioned Device Mounting With Spanner Bar Accessory.

A product of Denier Manufacturing. 10891 State Route 128 Harrison, Ohio, 45030  
1-800-286-9601 @ www.roughinready.com

## When It Is Necessary To Place The Electrical Box Between Studs:

- Far Side Supports** come bent at 90° angle for 3 5/8" studs. For 3 1/2" and 2-1/2" stud depth, bend at the additional provided slots.
- For stud depths of 5-1/2" or 6" use the **Far Side Extensions** (Ordered Separately). Slide the tab into the slot so that the small holes align. Secure with a small sheet metal screw. Bend at slot for 5-1/2" stud depth.
- Using the **Spanner Bars** (provided), attach the lower bar across the studs at 3" below the desired device height. Mount the Conduit Bracket onto the Spanner Bar using the lower tabs.
- Install the upper **Spanner Bar** into the upper tabs then secure the bar to the stud and bracket with screws.
- When terminating a conduit into this box, remove the **Plaster Ring Assembly** from the mounted Conduit Bracket. Box will remain attached to the bracket. Install conduit and wire as per **NFPA 70 National Electric Code** requirements.
- To install an AC-MC **Cable Whip** remove the KO and snap the connector into the box.
- Terminate the appropriate conductors to the device with Wagos (provided) and reattach the **Plaster Ring Assembly** to the mounted Conduit Bracket.

